

## **SECTIONAL VIEW**

THE MAXIMUM DRILLING DEPTH SHOULD BE 2 INCHES (50 MM). PLEASE REFER TO THE WATER PIPE LINE DRAWINGS TO DETERMINE WHERE THE CABINET IS TO BE FIXED AGAINST THE TOILET WALL.

## **WALL HUNG CABINET FIXING METHOD ISOMETRY**

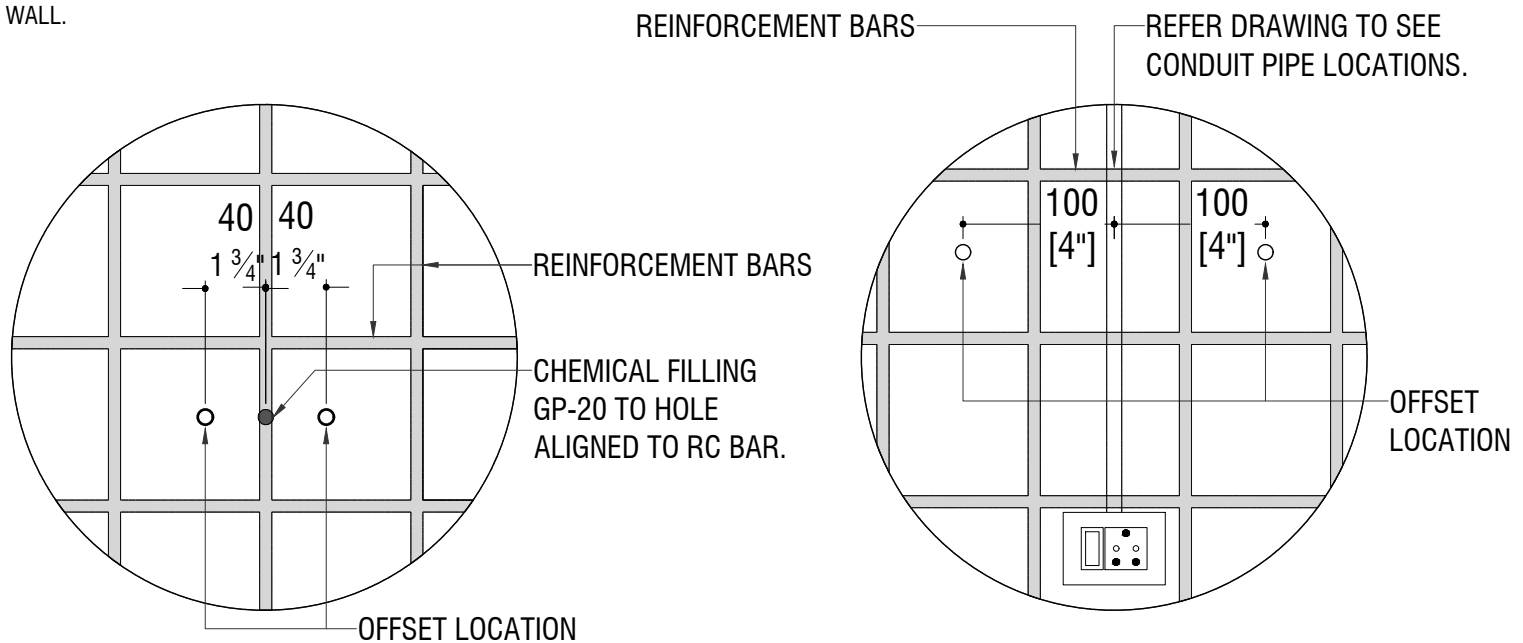

## **DRILLING LOCATION ADJUSTMENT**

IF THE DRILLING LOCATION ALIGNS WITH A WALL REINFORCEMENT BAR, RE-DRILL WITH A 1 3/4 INCH (40 MM) OFFSET FROM THE ORIGINAL DRILLED LOCATION. IN THIS CASE, FILL THE HOLE THAT ALIGNS WITH THE RC BAR USING GP-20 HIGH STRENGTH NON-SHRINK GROUT.

## **DRILLING LOCATION WITH CONDUIT**

REFER TO CONDUIT PIPE LOCATION DRAWINGS TO SEE THE WALL AREAS WHICH CANNOT BE DRILLED. (REFER TO ANNEX.) IF THE DRILLING LOCATION ALIGNS WITH A CONDUIT PIPE, THERE SHOULD BE A MINIMUM OF 4 INCHES (100MM) FROM BOTH SIDES OF THE CONDUIT.